

# Choosing a Material Palette

When you create a project, you will be prompted to select a [material palette](#). This palette determines the composition of the walls, floors, windows, doors and radiators that can be used within a project.

Click on each palette to preview what materials are selected for each section (External Wall, Internal Wall, Floor, etc.). You will be able to make adjustments to the selected palette from within the Plan task. Once selected, click *Use Palette* in the bottom left.

The screenshot shows the 'Choose Your Palette' interface. On the left, there are three palette options: 'No Presets' (Blank project, Start without palette), 'Heatpunk' (Building Regs 2022 - Limit New Dwellings, 12 Materials), and 'Team' (Team Palette, 16 Materials). A 'Manage Palettes' button is in the top right. A 'Use Palette' button is at the bottom left. On the right, a preview of the 'Team Palette' is shown, listing materials for different sections: External Wall (3), Internal Wall (2), Floor (2), and Intermediate Floor (1). The 'External Wall (3)' section is expanded, showing three materials: 'Brick 102mm, cavity, brick 102mm, 13mm plaster' (Thickness: 264 mm, u: 1.37, starred), 'Brick 102mm, 50mm mineral slab, brick 102mm, 13mm plaster' (Thickness: 267 mm, u: 0.56), and 'Stone 457mm (18in)' (Thickness: 457 mm, u: 2.23).

If you select *No Presets*, you can build a palette from scratch but this will not save to your material library. Click *Manage palettes* in the top right to navigate to your material library to [create default palettes](#) or edit existing ones.

## Using a palette in a project

When creating your floor plan, the **default** (starred) materials will be used for each external wall, internal wall, floor, etc. Each material has a **key** (patterned square) so you can see where each is being used in the floor plan.

Click on each component to **view the full material details** and **make changes**.

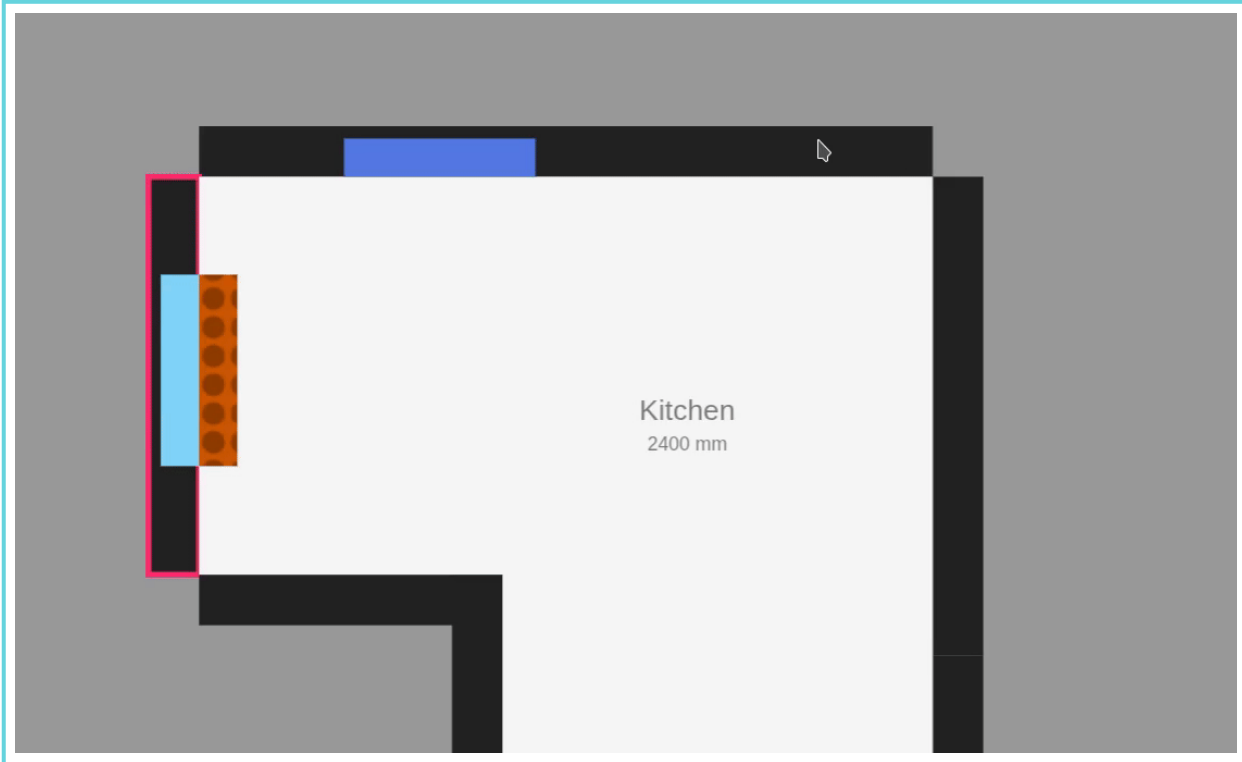

## Editing palette within a project

In this same menu, you can click *Add Material* to make project-level changes to the palette.

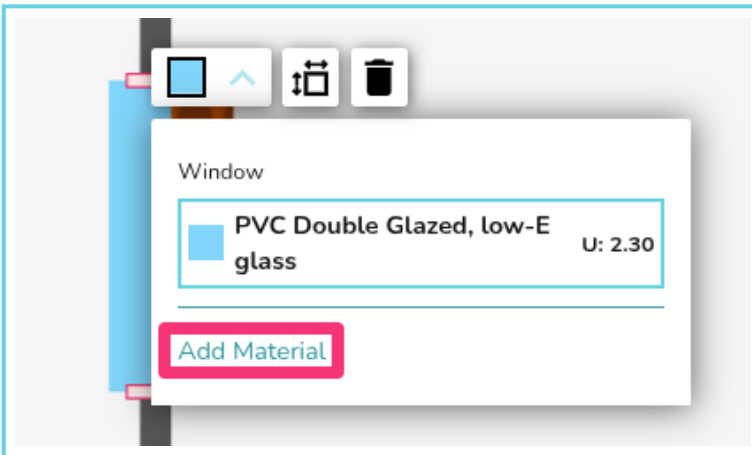

Click *Close* in the bottom left to save these changes.

If you have further questions, please get in touch at [help@heatpunk.co.uk](mailto:help@heatpunk.co.uk) or [help@heatpunk.ie](mailto:help@heatpunk.ie).

Revision #25

Created 5 January 2026 10:06:25 by Daisy

Updated 5 May 2026 11:49:50 by Daisy