

Creating Rooms

This guide covers how to size a room to the correct shape. For information on adjusting the properties of a room, see [Creating a Floor Plan](#).

Rooms can be dragged and dropped onto your floor plan from the left-hand sidebar

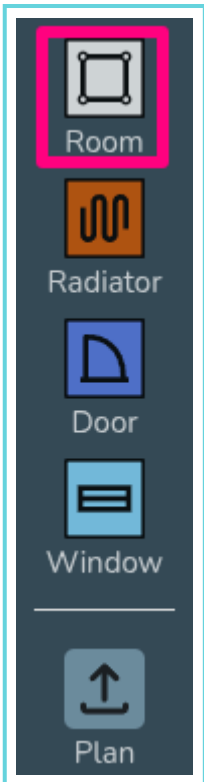

Adjusting shape of room

When creating a room in the plans task, there are a variety of different handles you can use to accurately adjust the shape of a room:

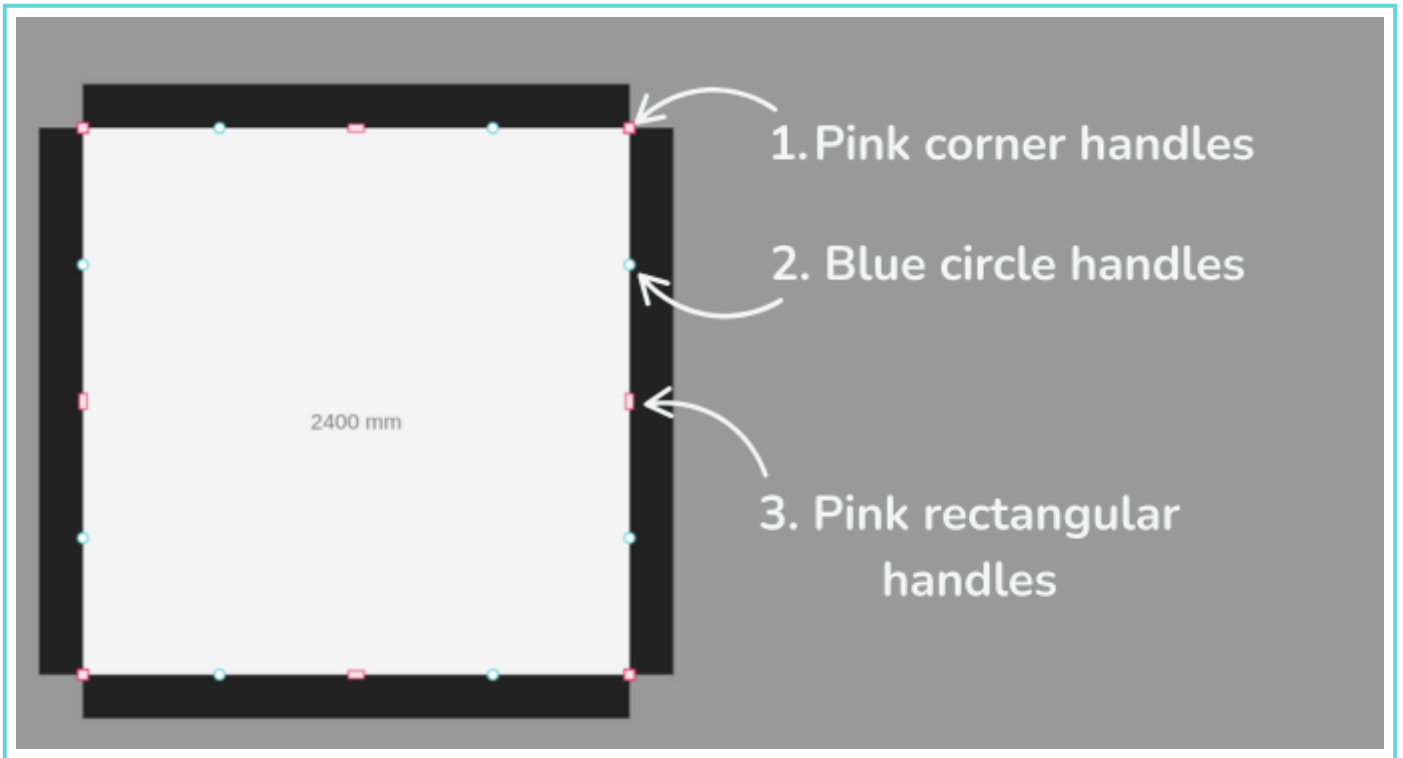

1. Pink corner handles

Click the **pink corner handles** to show dimensions of the associated walls. You can then click on the values to manually change these.

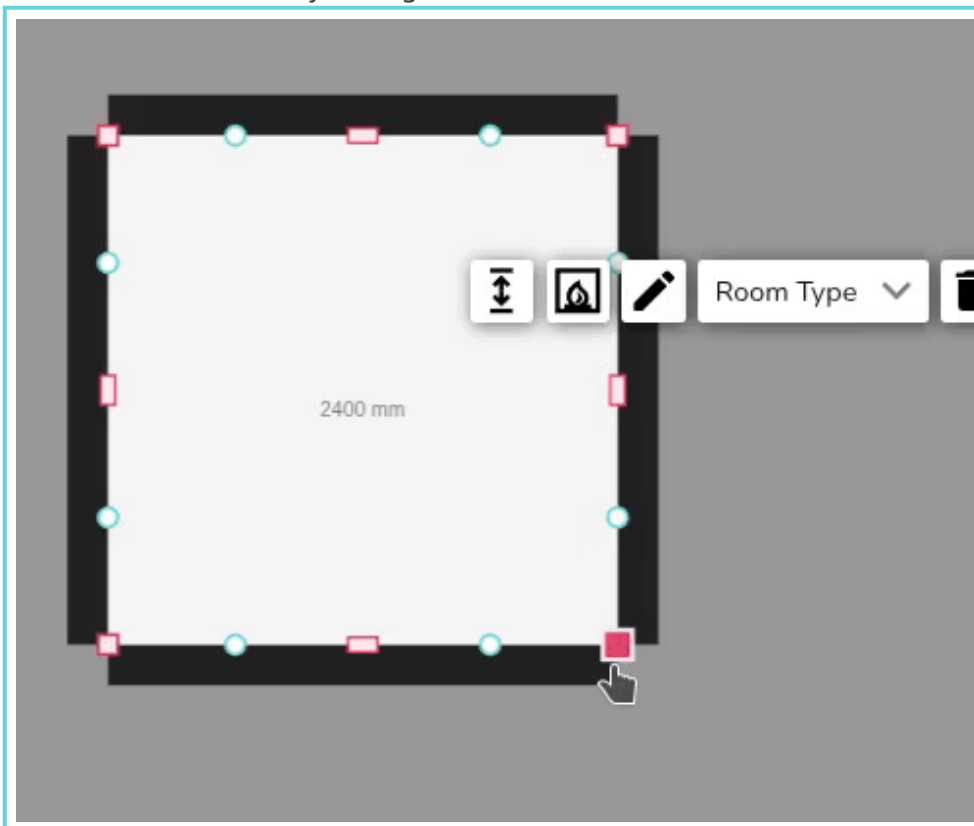

Click on the pink corner handles to switch between a square and circle handle:

- Use the **square corner handles** to resize the room whilst keeping the adjacent walls at the **same angle**.
- Use the **circle corner handles** to move that point **independently** of the other points to create angled walls.

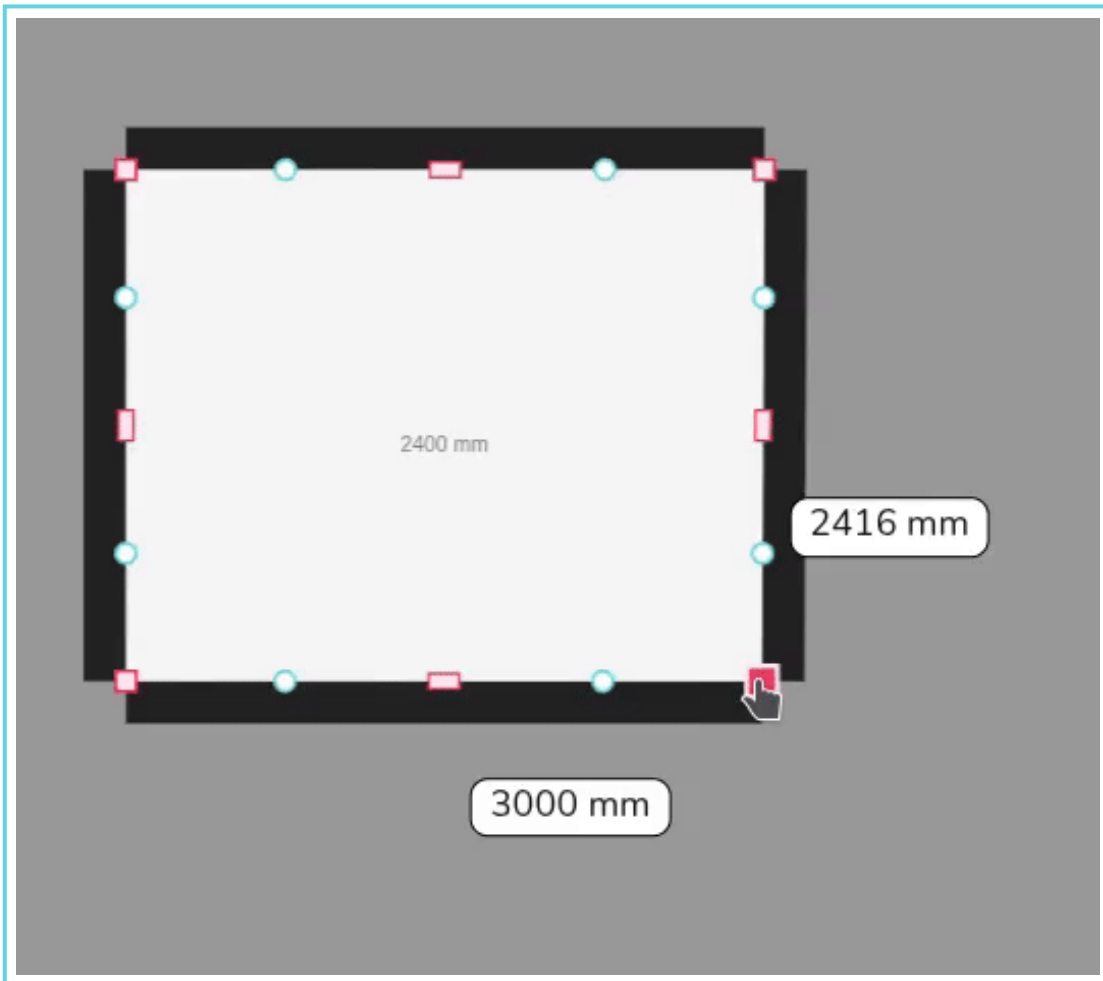

2. Blue circle handles

Click and drag the **blue circle handles** to allow you to split a wall and create irregular shapes. These will then convert to pink handles which you can delete if needed.

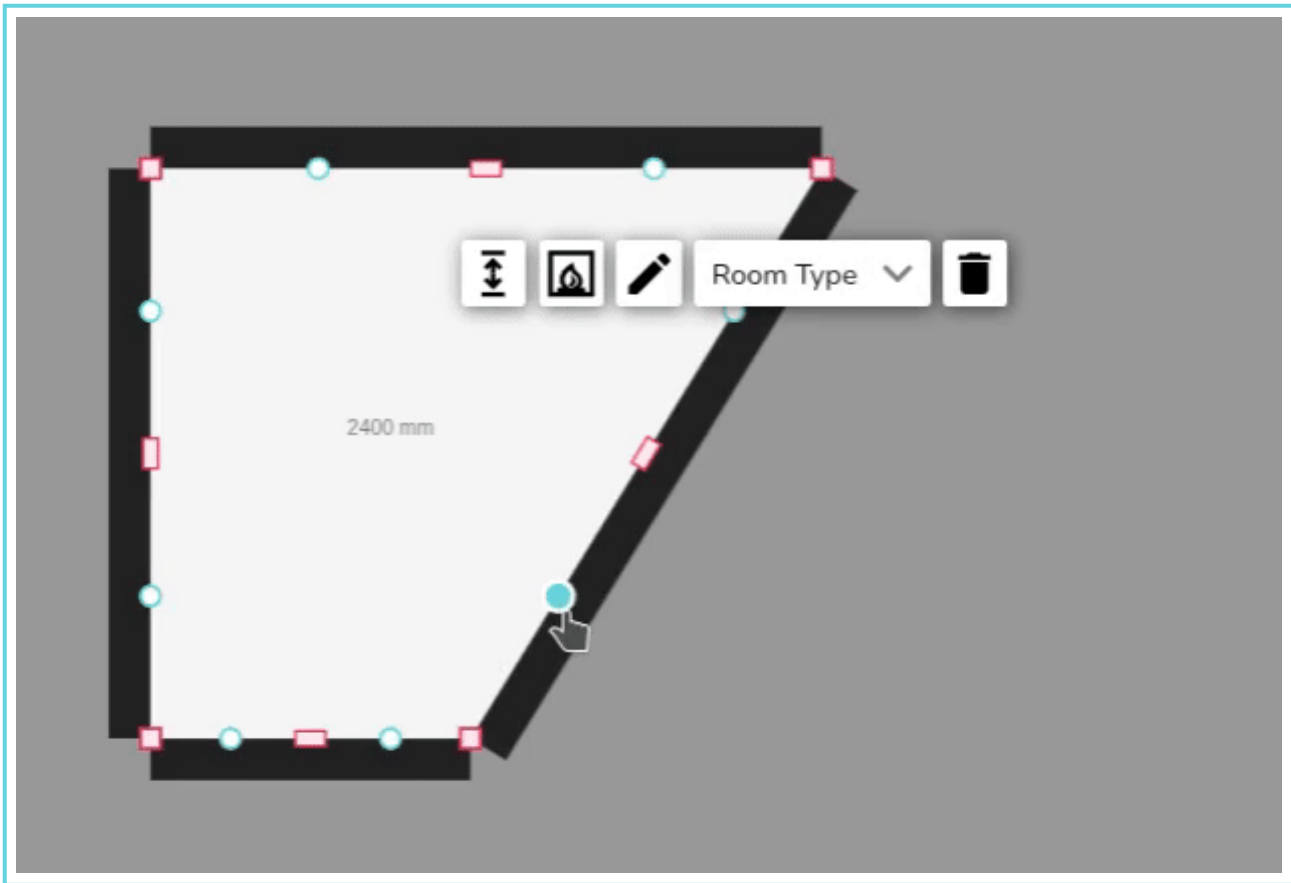

3. Pink rectangular handles

Use the rectangular handle to resize the room. Click on the **pink rectangular handles** to toggle between a square and curved cornered handles:

- Use the **square cornered handle** to extend a wall out.
- Use the **curved cornered handle** to extend the adjoining wall independently of the others.

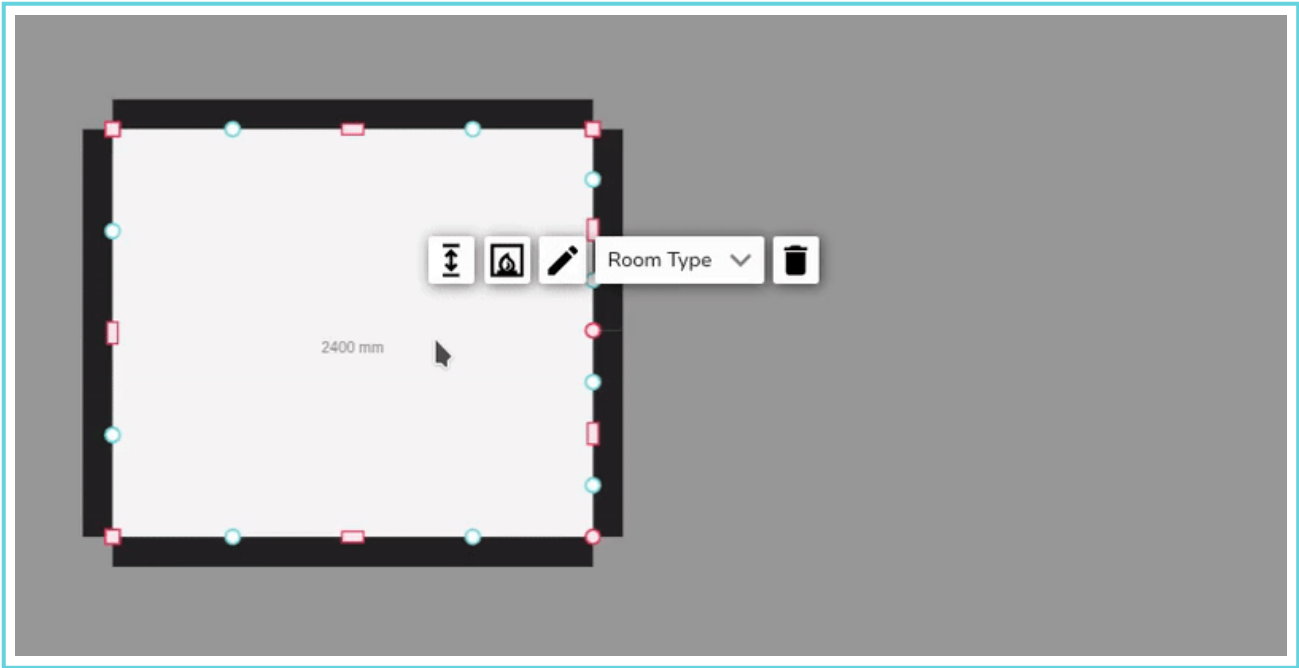

Video demonstration

These tools are demonstrated in the video below.

<https://www.youtube.com/embed/0e9BZdiPjgc?t=154s>

If you have further questions, please get in touch at help@heatpunk.co.uk or help@heatpunk.ie.

Revision #18

Created 19 November 2024 17:30:46

Updated 5 May 2026 11:50:44 by Daisy