

Emitters

Emitters are added to a project in the [Plan task](#). Here you can model existing emitters and any necessary upgrades.

Add **existing emitters** to the **surveyed plan** and adjust the flow temperature on the right-hand sidebar to clearly see where upgrades are needed. On a [design option](#) you can then model these **emitter upgrades**.

Below is a short video demonstrating how to add and upgrade radiators and underfloor heating.

<https://www.youtube.com/embed/yEq-42VrHLU>

Emitters tab

As you build your floor plan, you can access a range of controls and details in the *Emitters* tab:

Sources Hot water **Emitters** Accessories

Ground floor Change floor ▾

⊗ **Emitter output:** 3943 W / 4512 W

Sufficient rooms: 2 / 7

Emitters ⓘ

Total emitter output: 8928 W
Total annual demand: 26428 kWh/year

Living room **Met** 1155 / 1141 W ↗ ⓘ ^

Underfloor heating 16.5 m² 1155 W New ...

K2 600 mm x 1000 mm 783 W Removed ...

Hall **Not met** 0 / 361 W ↗ ⓘ ▾

Study **Not met** 454 / 551 W ↗ ⓘ ▾

Bath **Not met** 0 / 318 W ↗ ⓘ ▾

Utility **Not met** 0 / 242 W ↗ ⓘ ▾

Dining **Not met** 783 / 785 W ↗ ⓘ ▾

Kitchen **Met** 1551 / 1115 W ↗ ⓘ ▾

Edit emitter details

Delete emitter

Restore emitter

- View heat loss information per floor and navigate between floors
 - **Emitter output:** total floor emitter output / total floor heat loss
 - **Sufficient rooms:** no. of rooms where heat loss is met / no. of rooms where heat loss is not met
- Hover over the ⓘ icon next to **Emitters** to view the **total emitter output** and **annual demand** for the property
- For new or existing emitters, click ... **three dots** to edit details or delete. On removed emitters click the ... **three dots** > **Restore emitter** to add it back to the design option
- Each room displays whether the heat loss is met and the **room emitter output / room heat loss**
- Click ⓘ to **see room details** to add other emitters or view the room annual demand, element heat loss, volume and area.
- Click the **exclamation icon to override the heat loss** for that room

Edits to existing emitters from the *Emitters* tab apply to all plans. Read about [emitter upgrades](#) below.

While on the *Emitters* tab, as you adjust the **flow temperature**, you can see directly on the floor plan whether the heat loss is being met:



UFH and other non-radiator emitters have a **fixed output** that does not change with flow temperature in Heatpunk. As seen above, the living room output remains the same.

Adding emitters

You can add emitters in both the *surveyed plan* and design options. Emitters added to the *surveyed plan* will be added to all design options, while emitters added within a design option are only added to that option.

Adding radiators

To place radiators on a floor plan, drag and drop from the right-hand sidebar.



Click on the radiator to edit the type and size or remove from the plan. If the type you are looking for isn't listed, click *Add Material* to add radiators to your [material library](#).

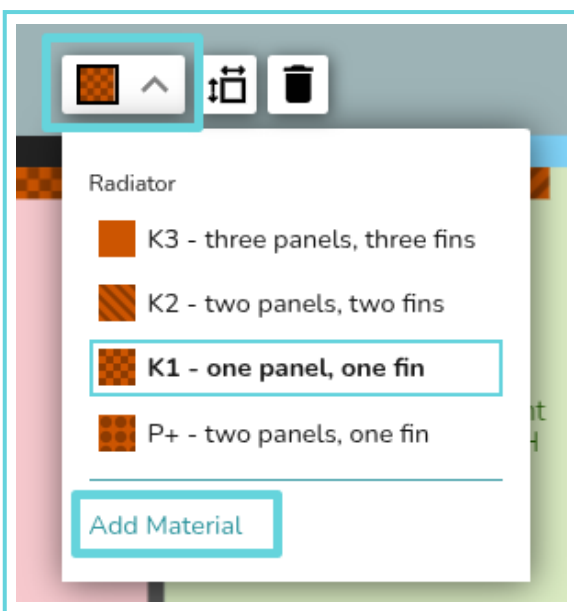

Adding underfloor heating or other emitters

To add underfloor heating, navigate to the **Emitters tab** and click **See room details** on the room. Below the room details, then click *Add underfloor heating* or *Add other emitters*. Fill in the details and then save changes.

The screenshot displays a software interface for managing a heating system. On the left, a floor plan is shown with rooms labeled: Kitchen (60% sufficient, 18°C 2 ACH), Dining (71% sufficient, 21°C 1.5 ACH), Bath (0% sufficient, 18°C 3 ACH), Utility (0% sufficient, 18°C 3 ACH), Living room (0% sufficient, 21°C 1.5 ACH), Hall (0% sufficient, 18°C 2 ACH), and Study (59% sufficient, 21°C 1.5 ACH). A toolbar above the plan includes icons for selection, deletion, and a dropdown menu currently set to 'Living room'. At the top left, there are tabs for 'Surveyed plan' and 'Option 1'. On the right, a sidebar titled 'Project Overview' shows 'Surveyed plan' selected. It displays system metrics: 9.5 kW, 133 m², 71 W/m², and a Delta Ts of 45°C. Below this, a summary for the 'Ground floor' shows an emitter output of 1563 W / 4512 W and 0/7 sufficient rooms. A list of rooms follows, each with a status (e.g., 'Not met') and power requirements. A note at the bottom of the sidebar asks 'Looking to add new heat emitters?' and provides instructions on how to add them.

Emitter upgrades

To complete emitter upgrades, make sure you have a **design option** selected. When you add, upgrade, or remove emitters, this is clearly labelled for each room:

This close-up shows the emitter list for the 'Kitchen' room, which is marked as 'Met' with a total capacity of 1602 / 1530 W. Three radiator units are listed:

- K1**: 600 mm x 1000 mm, 390 W. Status: **Removed**.
- K2**: 600 mm x 1000 mm, 671 W. Status: **Existing**.
- K3**: 600 mm x 1000 mm, 932 W. Status: **New**.

- **Existing**: emitters added to the *surveyed plan*
- **Removed**: existing emitters deleted or replaced on a design option
- **New**: emitters added to a design option

If a radiator you've added is of the wrong type, remove the radiator, navigate to the correct floor plan (surveyed plan or a design option) and re-add the radiator.

Radiator upgrades

Click on the radiator on the plan and then click upgrade.

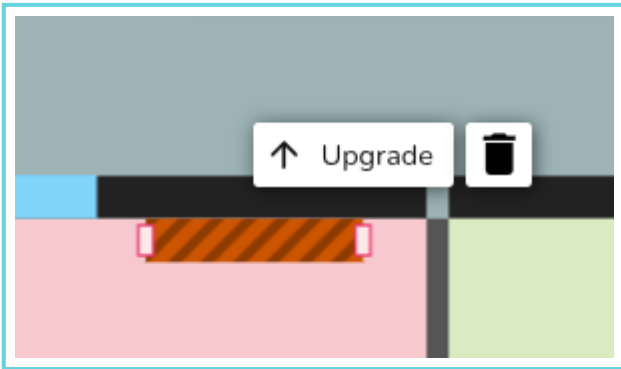

You can then edit the details of the existing emitter.

Customise radiator

K3
3 panels,
3 fins

K2
2 panels,
2 fins

K1
1 panel, 1
fin

P+
2 panels,
1 fin

[+]
Custom
radiator

Height
800 mm

Width
1000 mm

Cancel **Save changes**

103%

1115 W
Room Demand
✓ Met

K3 (800mm × 1000mm) 1150 W

Clicking *Save changes* will delete the existing radiator from the floor plan and replace it with the new radiator.

Kitchen **Met** 1150 / 1115 W ↗ ⓘ ^

K2 600 mm × 1000 mm 671 W Removed ...

K3 800 mm × 1000 mm 1150 W New ...

Underfloor heating and other emitters upgrades

If you are replacing the radiator with underfloor heating (or another emitter), **delete** the radiator from the plan and follow the steps [above](#) to add UFH/other emitters to a project.

Overriding heat loss

To override the heat loss on a room, click the **exclamation** icon. Input the reason for the override and save. That text will then display in the technical report.



The text will also appear on the floor plan. To view the full text, click **See room details**

If you have further questions, please get in touch at help@heatpunk.co.uk or help@heatpunk.ie.

Revision #43

Created 2 April 2026 14:41:42 by Daisy

Updated 28 May 2026 08:00:11 by Daisy